

# PLAN REFERRED TO

FOR IDENTIFICATION PURPOSES ONLY

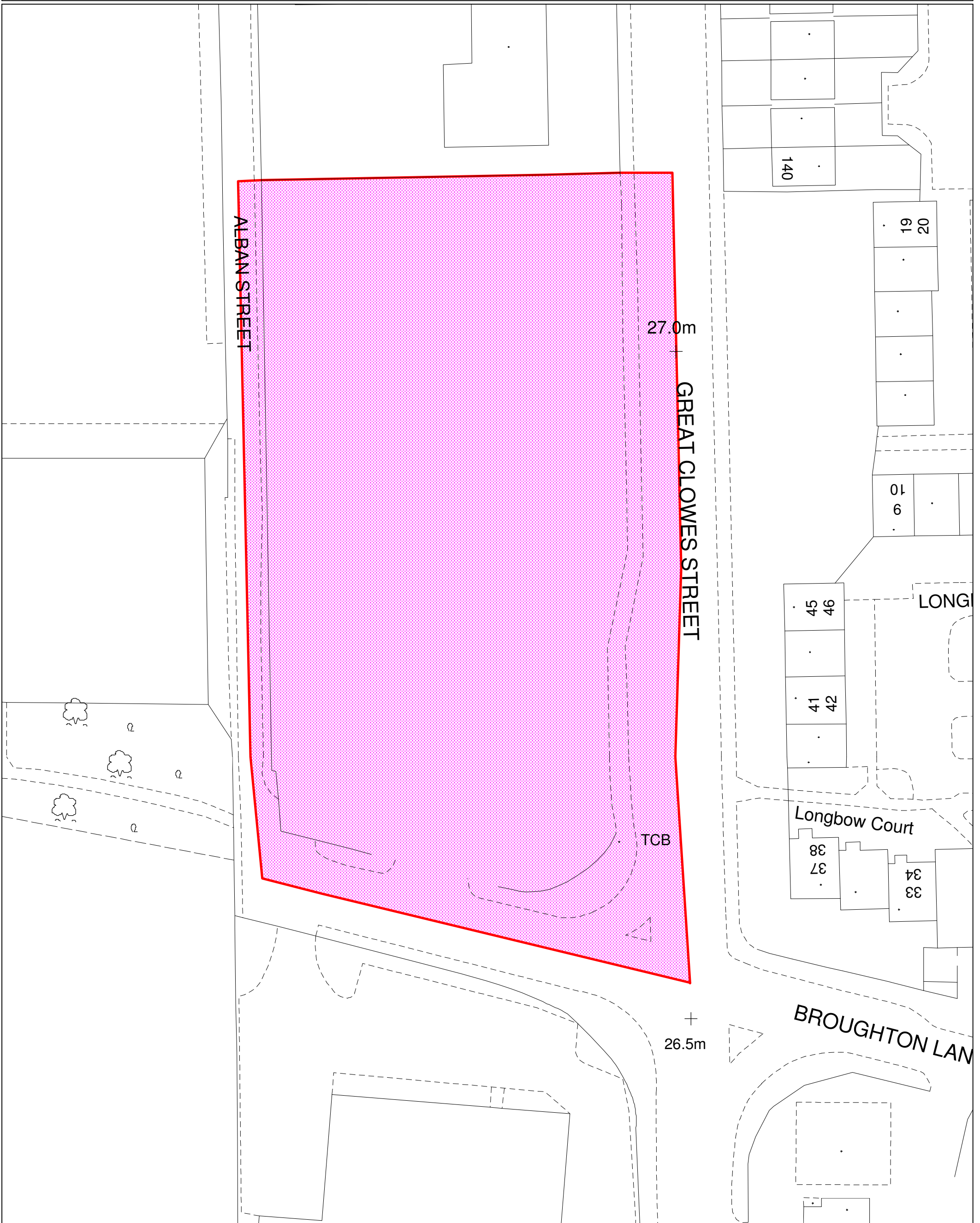

**Property and Development**  
Emerson House  
Albert Street  
Eccles M30 0TE  
[www.urbanvision.org.uk](http://www.urbanvision.org.uk)

**TITLE:**  
MAP REFERRED TO IN THE CITY OF SALFORD  
(LAND AT GREAT CLOWES STREET, SALFORD)  
COMPULSORY PURCHASE ORDER 2006

PLAN No: V/  
SCALE: 1:500  
AREA: 6674.70 sq metres  
DATE: 18/01/2007  
MAP REF: SD8200SE  
PRODUCED FROM THE ORDNANCE SURVEY MAP WITH THE PERMISSION OF THE CONTROLLER OF HER MAJESTY'S STATIONERY OFFICE CROWN COPYRIGHT RESERVED. LICENCE No: 100019737